

# MFA5028-CM1S

Type	MANUAL MONO		Mount	C		
Focal Length	50mm		Back Focus	21.2mm		
Fno.	F2.8		Mechanical Bf	13.5mm		
Designed Image Format	2/3"(6.6x8.8mm)		Exit Pupil	-29.56mm		
Operation Range	Iris	F2.8-22	Filter Size	-		
	Focus	0.5m ~ ∞	Aperture	Front	∅17.4mm	
	Zoom	-		Rear	∅ 8.4mm	
Control	Iris	Manual	TV Distortion	-0.2%		
	Focus	Manual		Vignetting	-28%	
	Zoom	-				
Object Size at MOD	51.1 x68.1mm		Dimension	∅29x38.5mm		
	-		Weight	55g		
Field of View	V	7.4°	1/2"	5.5°		
	H	9.9°		7.3°		
	D	12.4°		9.1°		
Operating Temperature	-10°C ~ +50°C					

## DIMENSIONS

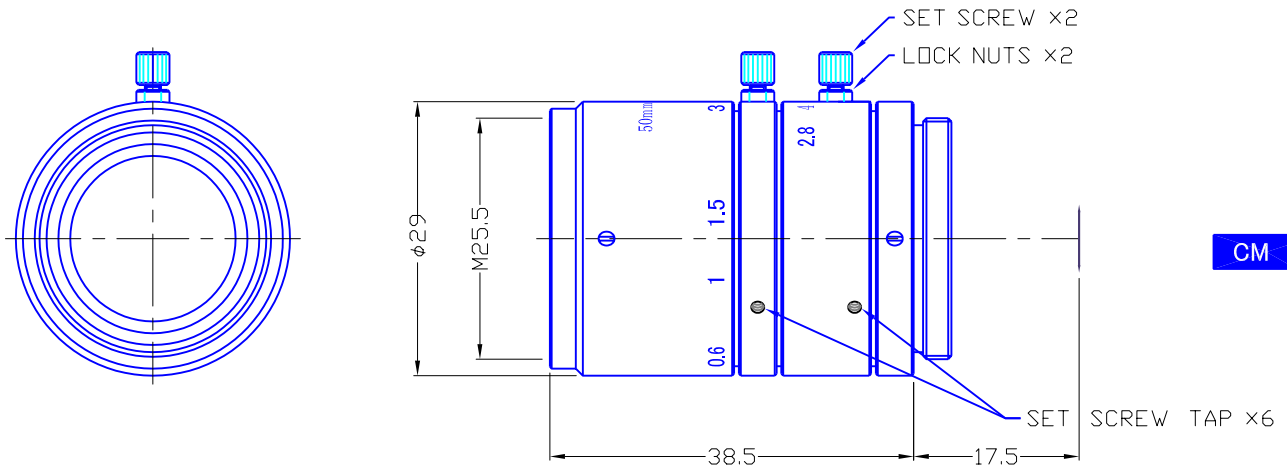

## MAGNIFICATION

( ) : 14" MONITOR TV	O/I = 3000mm : -0.01725X (0.56X)	O/I = 700mm : -0.08479X (2.74X)
	O/I = 1500mm : -0.03587X (1.16X)	O/I = 500mm : -0.12917X (4.18X)
	O/I = 1000mm : -0.05607X (1.81X)	